

GENERAL SPECIFICATION OF MD89MW MICRO SIZE CORELESS MOTOR TORQUE SERVO

1. TECHNICAL VALUE

CONTROL SYSTEM	:+PULSE WIDTH CONTROL 900~2100us,1500us NEUTRAL		
OPERATING VOLTAGE RANGE	:4.8V TO 7.4V		
OPERATING TEMPERATURE RANGE	:-20° C TO +60° C(-4° F TO +140° F)		
TEST VOLTAGE	:AT 4.8V	AT 6.0V	AT 7.4V
OPERATING SPEED	:0.17sec/60° AT NO LOAD	0.13sec/60° AT NO LOAD	0.11sec/60° AT NO LOAD
STALL TORQUE	:5.3kg.cm(73.6oz.in)	6.4kg.cm(88.88z.in)	8.5kg.cm(118.04oz.in)
STANDING TORQUE	:-		
IDLE CURRENT	:30mA AT STOPPED	30mA AT STOPPED	30mA AT STOPPED
RUNNING CURRENT	:200mA	250mA	300mA
STALL CURRENT	:1,800mA	2,340mA	2,900mA
DEAD BAND WIDTH	:1us	1us	1us
OPERATING TRAVEL	:40±5° /ONE SIDE PULSE TRAVELING 400usec		
DIRECTION	:CLOCK WISE/PULSE TRAVELING 1500 TO 1900usec		
MOTOR TYPE	:CORELESS METAL BRUSH		
POTENTIOMETER TYPE	:MAGNETIC ENCODER		
AMPLIFIER TYPE	:DIGITAL AMPLIFIER WITH MOSFET DRIVE		
DIMENSIONS	:29x13x30mm(1.14x0.51x1.18in)		
WEIGHT	:25.0g(0.88oz)		
BALL BEARING	:DUAL BEARING		
GEAR MATERIAL	:5 METAL GEARS		
HORN GEAR SPLINE	:25 SEGMENTS/∅6.00		
SPLINED HORNS	:M-O25		
CONNECTOR WIRE LENGTH	:200mm(7.87in)		
CONNECTOR WIRE STRAND COUNTER	:60EA		
CONNECTOR WIRE GAUGE	:22AWG		

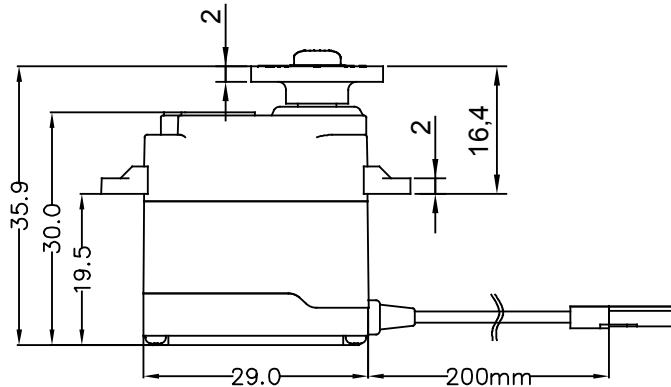
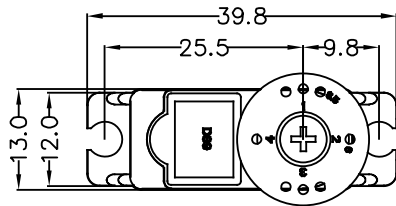

2. FEATURES

- PROGRAMMABLE HIGH RESPONDENCE DIGITAL AMPLIFIER WITH MOSFET DRIVE
- DURABLE METAL GEARS WITH DUAL BALL BEARING
- :MAGNETIC ENCODER

3. APPLICATIONS

- 1500mm Wing Span Air Plane